

PRACTICE **MOCK**

GET IT ON
Google Play



CRACK SSC EXAMS

WITH QUALITY MOCK TEST SERIES

SSC GD
CONSTABLE

~~199/-~~
159/-

PM SSC
PRO
6 MONTHS

249/-

PM SSC
PRO
12 MONTHS

399/-

PM PREMIUM
PACKAGE
Banking, SSC & Others

999/-

Features

- * Free PDFs
- * Test Series
- * Live Mocks
- * Free Classes
- * Free Quizzes

SSC GD Constable Free
Crash Course 2022

**Distance and Direction Class
Notes**

DOWNLOAD **FREE** PDF



Direction Sense and Distance:

Primary Directions:

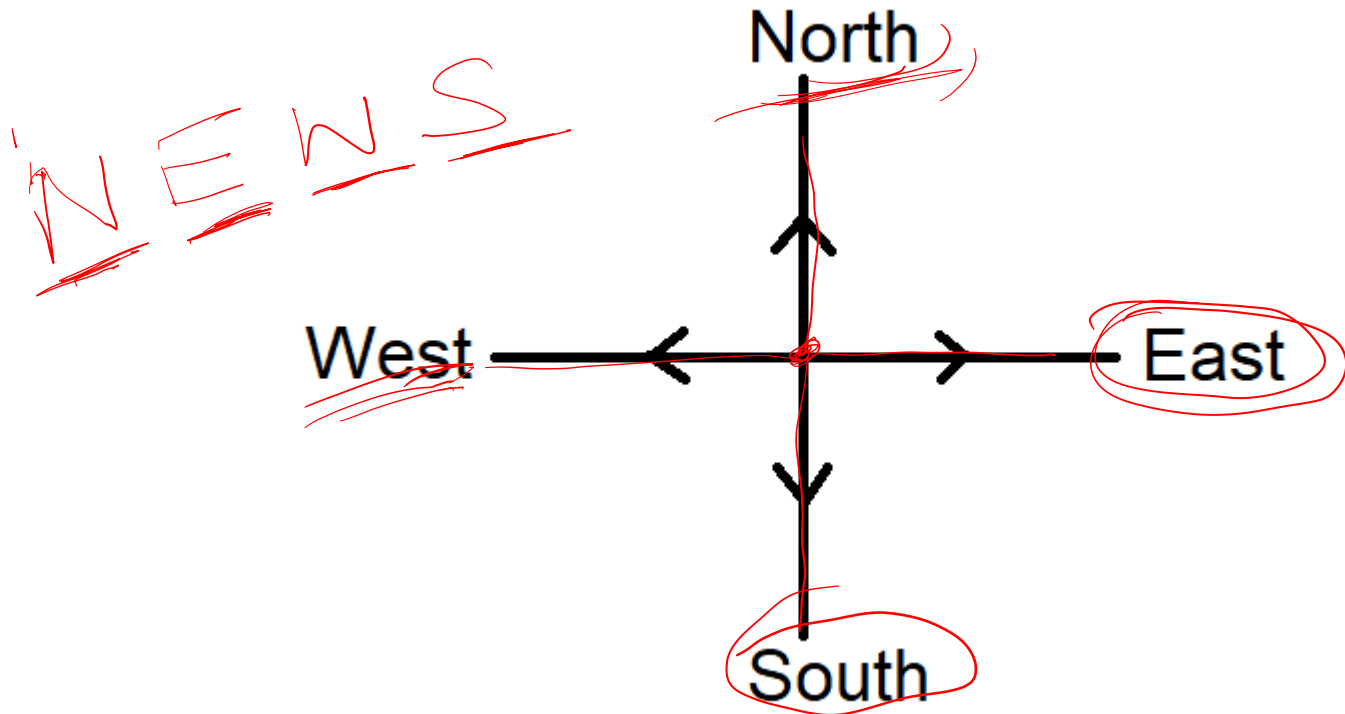

Direction Sense and Distance:

Left and right in Primary directions:

Left
Right

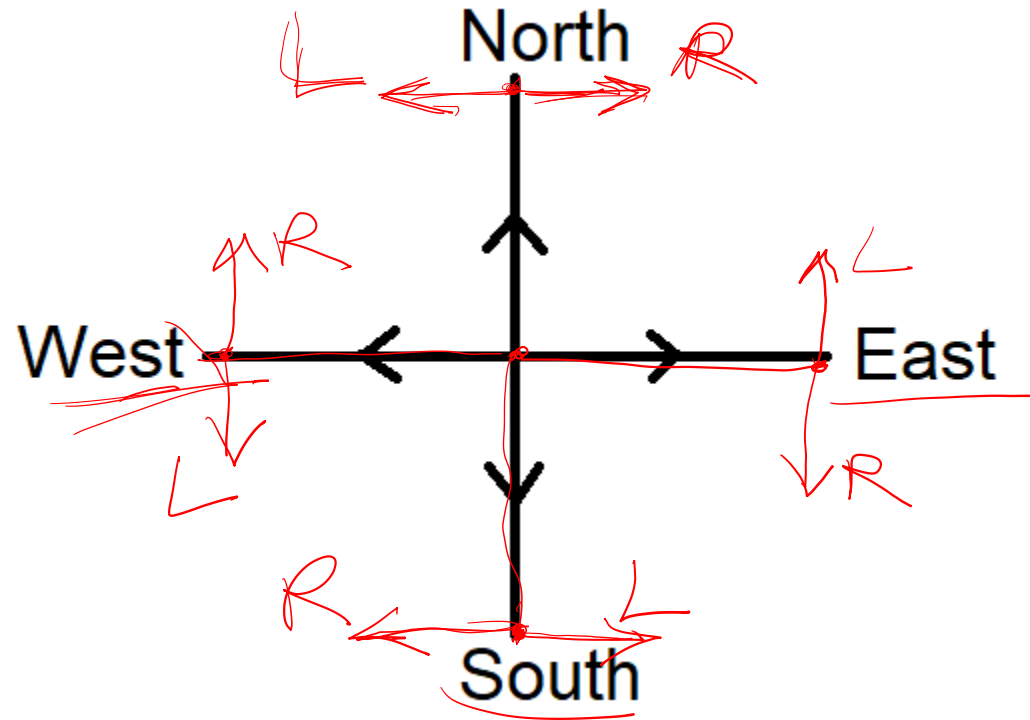

Direction Sense and Distance:

Understanding 8 Directions:

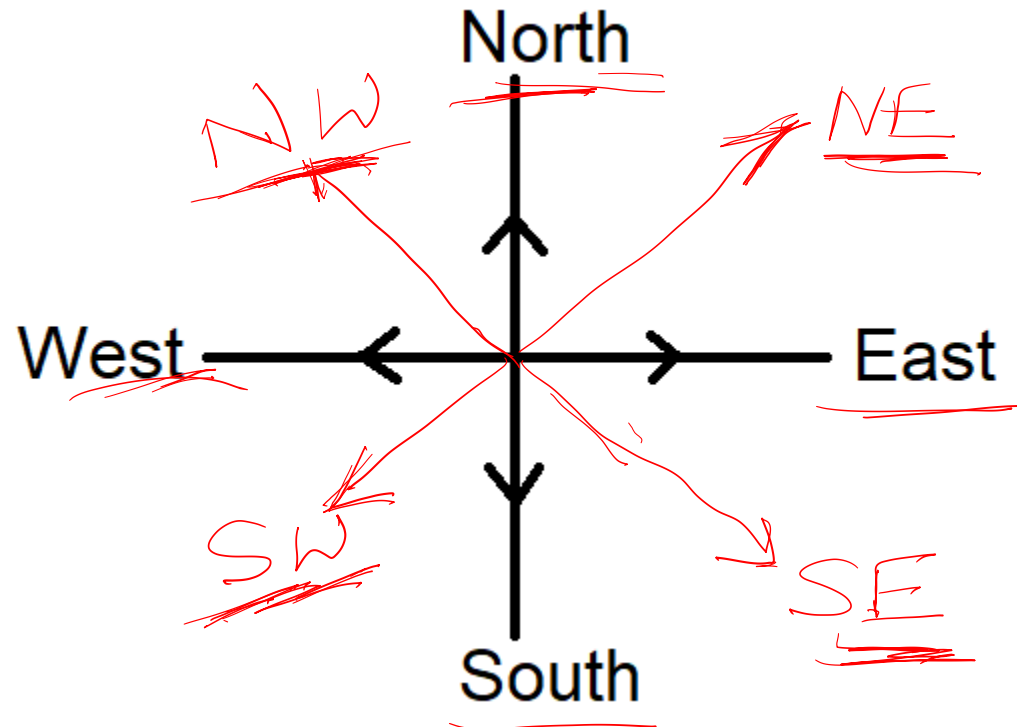

Direction Sense and Distance:

Understanding Angles:

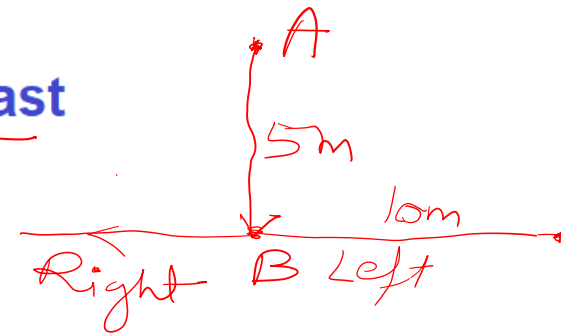
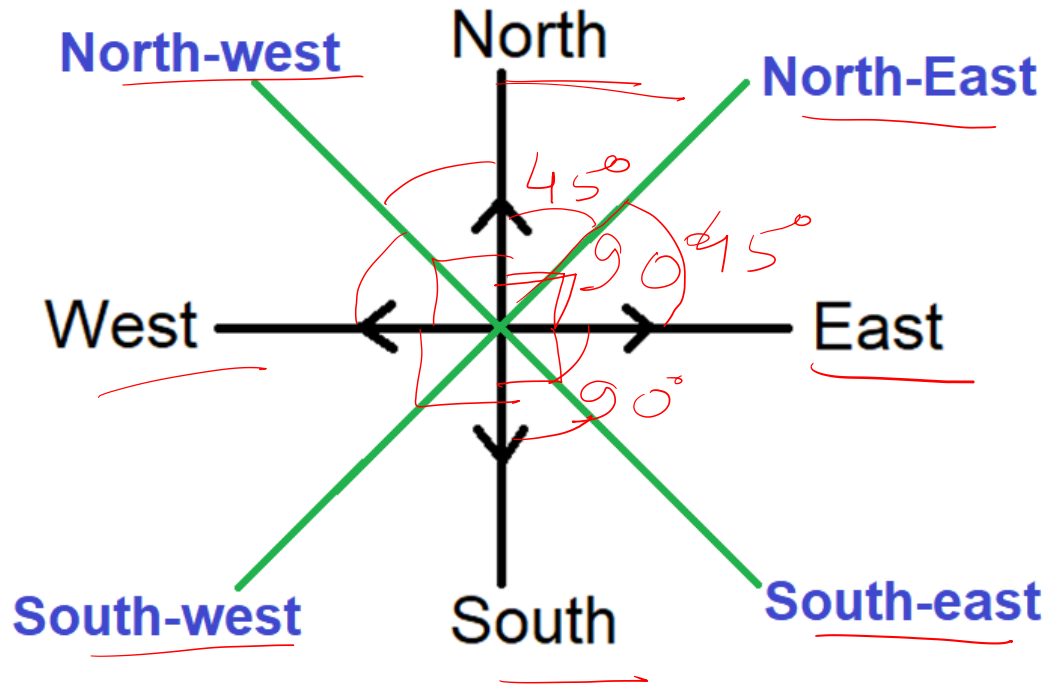

Direction Sense and Distance:

Clockwise Direction:

90° Clockwise
Right

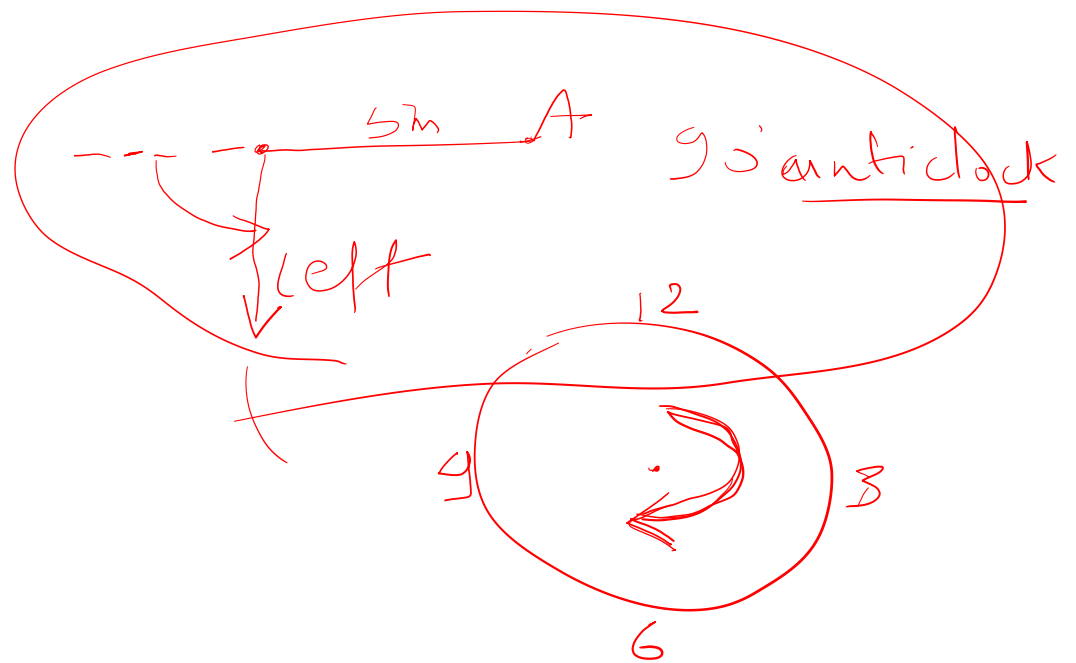

Anti-clockwise Direction:

90° Anti clockwise
Left



90° clockwise
→ Right

दिशा

दूरी

Direction Sense and distance:

Distance:

Pythagoras Theorem

$$AC^2 = AB^2 + BC^2$$

$$= (6^2 + 8^2) m$$

$$= (36 + 64) m$$

$$AC^2 = 100 m$$

$$AC = \sqrt{100 m} = 10 m$$

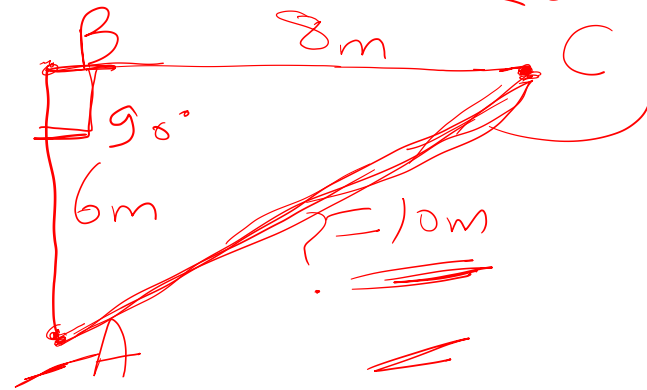
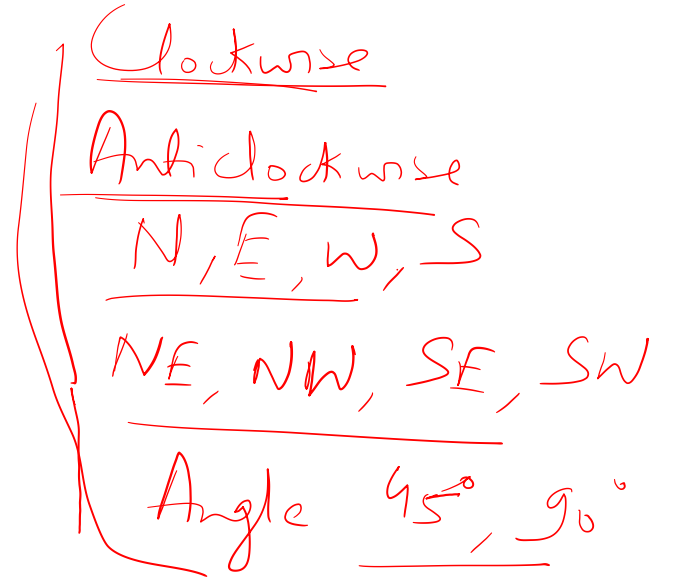

Direction Sense and distance:

Sun and Shadow:



7am Morning - East
5pm, Evening - West

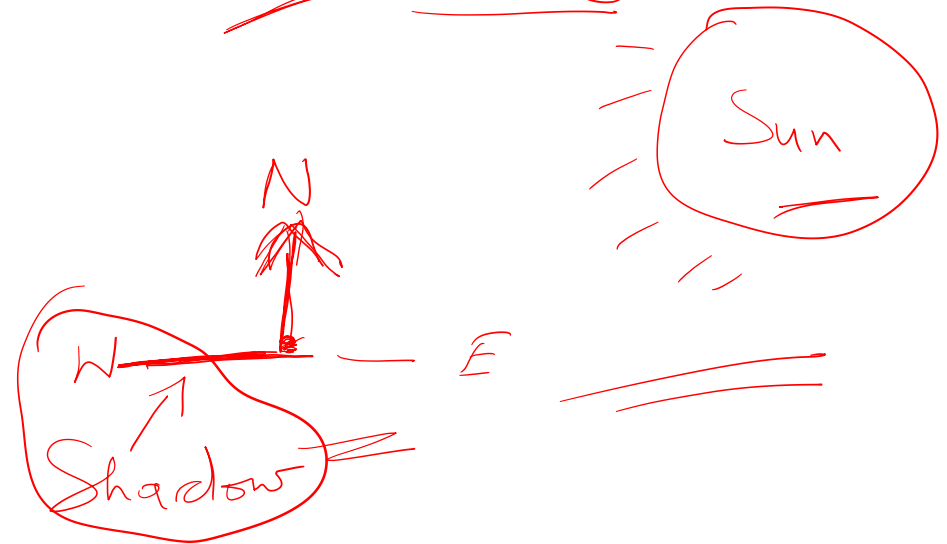

Direction Sense and distance:

90° Anticlock
- left

90° Clockwise
- Right

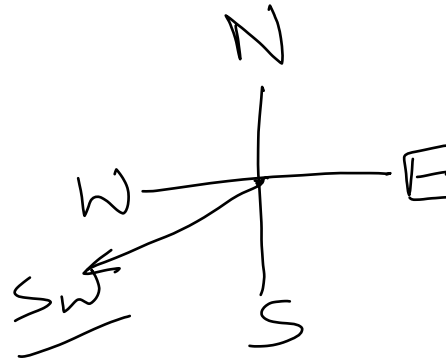
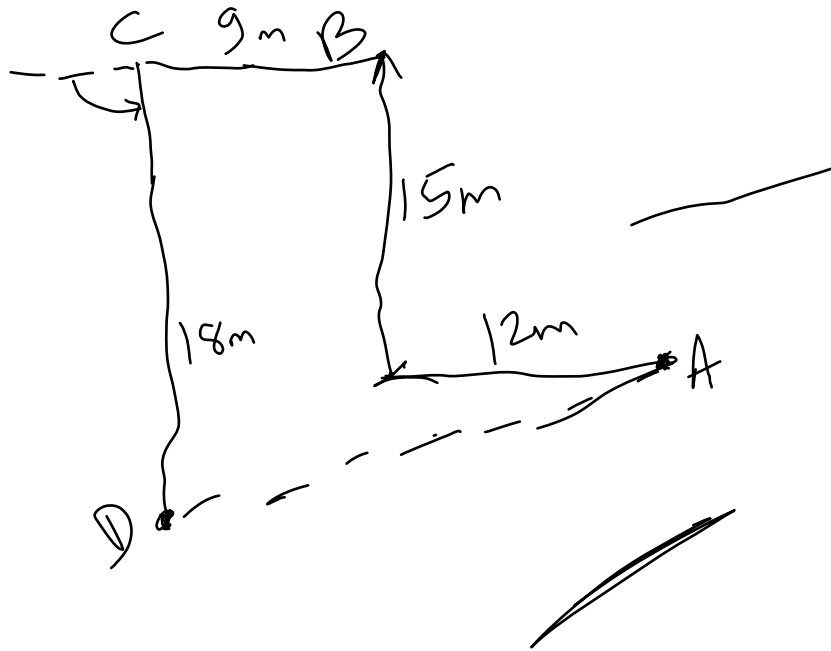

Question No 1

Ayu walks 12m from point A in west direction and then he turns to his right and walks 15m to reach point B. From here he turns to his left and walks 9m to reach point C, and then he turns 90° in anti-clockwise direction and walks 18m to reach point D. So, in which direction is point D with respect to point A?

- a) South-east
- b) North-west
- c) South-west
- d) North-east

Direction Sense and distance:

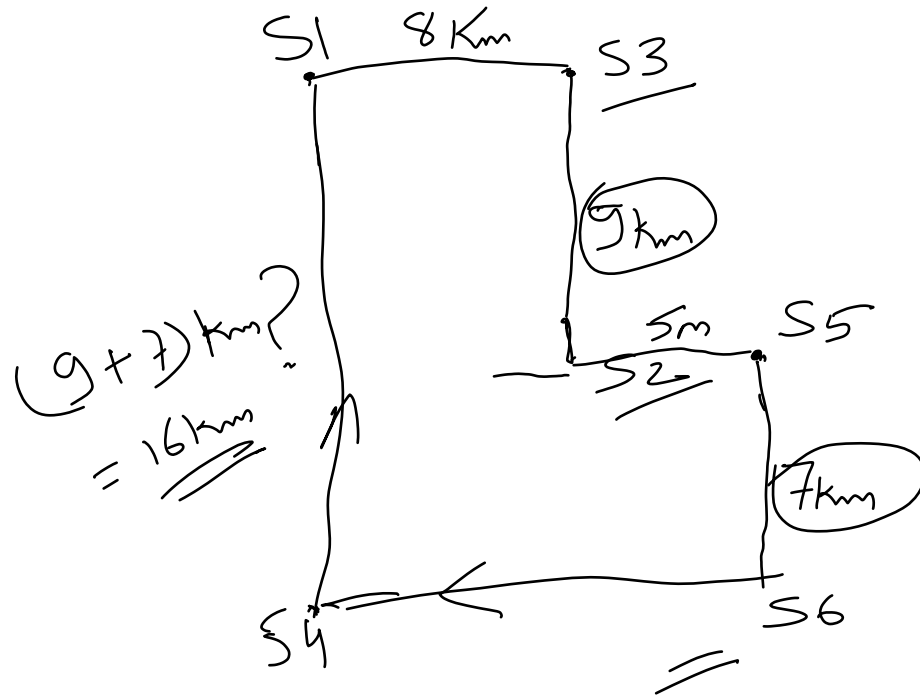

Question No 2

There are Six shops (S1, S2, S3, S4, S5 and S6) in a city. S1 is in 8km west of S3. S3 is 9km north of S2. S5 is 5km east of S2. S6 is 7km south of S5. S1 is north of S4, which is west of S6. What is the shortest distance between S1 and S4?

- a) 9km
- b) 16km
- c) 7km
- d) 8km

Direction Sense and distance:

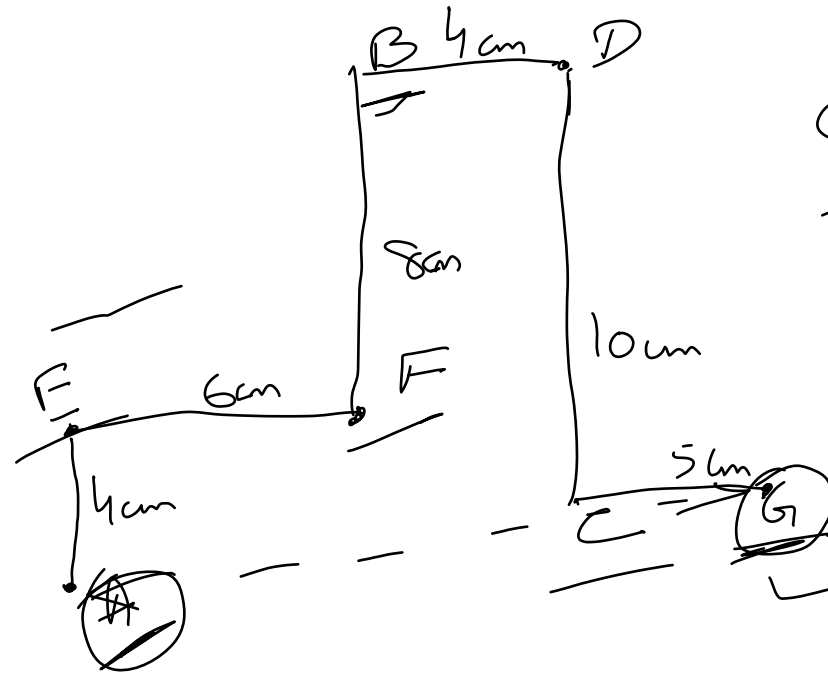
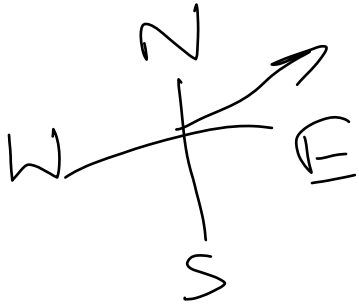

Question No 3

There are seven points drawn on a sheet of paper. If A is 4cm south of E. D is 10cm north of C. B is 4cm west of D. G is 5cm east of C. F is 6cm east of E. B is 8cm north of F, the what is the direction of G with respect to A?

- a) South west
- b) North west
- c) North east
- d) East

Direction Sense and distance:

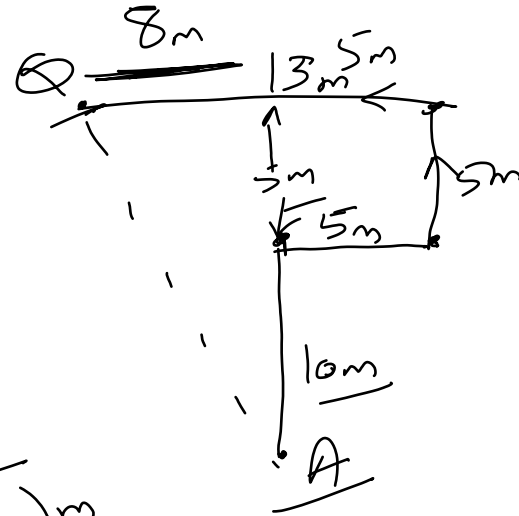

$$\begin{aligned} QA^2 &= 15^2 + 8^2 \\ QA^2 &= \sqrt{(225 + 64)} \text{m} \\ &= \sqrt{289} \text{m} \\ &= \underline{\underline{17\text{m}}} \end{aligned}$$

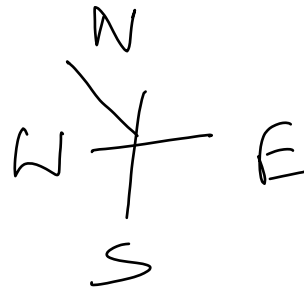

Question No 4

Starting from point A, Sudha walked 10m towards the north. From there she turned right and walked 5m. After that, she turned left and walked 5m. From there, she again turned left and walked 13m and reached a point Q. What is the shortest distance and direction of point Q with respect to point A?

a) 15m, North-east

b) 17m, North-west

c) 14m, North-east

d) 15m, North-west

Direction Sense and distance:

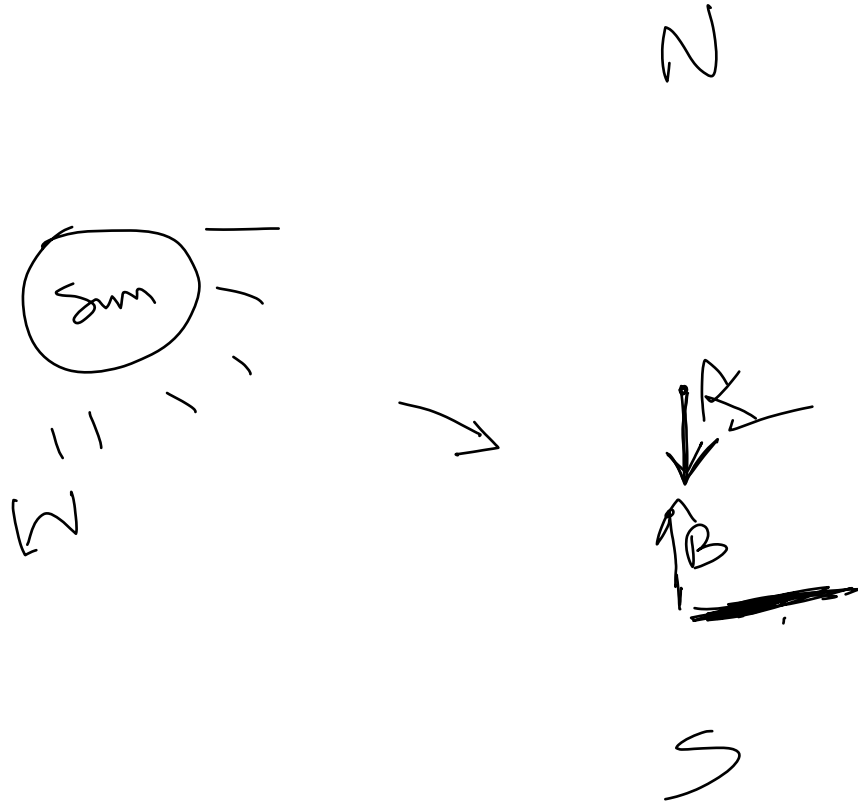

Question No 5

Bunty met Kanha while going to market in the evening. Kanha observed that Bunty's shadow was exactly to the right of Bunty. If they were facing each other, in which direction was Kanha facing?

- ⌈
- a) East
 - b) West
 - c) North
 - d) South

Direction Sense and distance:

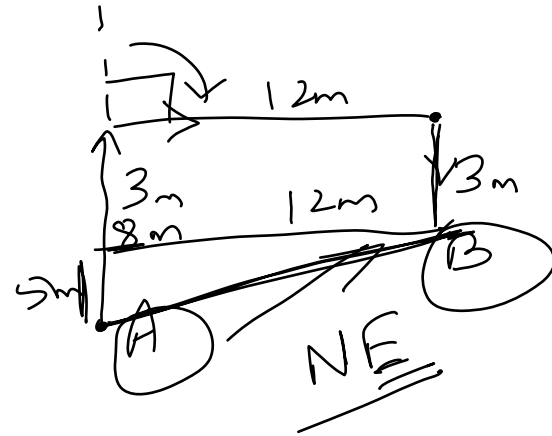

$$\begin{aligned} AB^2 &= (5^2 + 12^2) \\ AB &= \sqrt{(25 + 144)} \\ &= \sqrt{169} \text{ m} \\ &= \underline{\underline{13 \text{ m}}} \end{aligned}$$

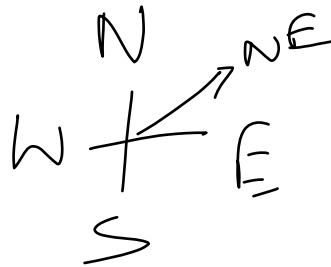

Question No 6

Anil starts walking in north direction from point A. After covering 8m, he turns 90° in clockwise direction and walks for 12m. Then, he turns right and walks for 3m to reach point B. What is the direction of Point B from Point A? Also, find the direction of point B with respect to point A.

- a. 17m, North west
- ~~b. 13m, North east~~
- c. 15m, South west
- d. 11m, North east

Direction Sense and distance:

$$\begin{aligned} ? &= \sqrt{(8+6)^2} \text{ m} \\ &= \sqrt{64+36} \text{ m} \\ &= \sqrt{100} \text{ m} \\ &= \underline{\underline{10 \text{ m}}} \end{aligned}$$

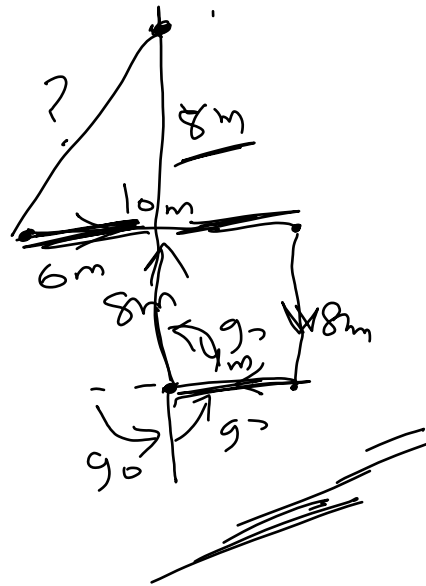

Question No 7

Anil walks for 10m towards east direction. He turns right and covers another 8m. He takes another right turn and covers 4m. Finally, he turns 270° anti clockwise direction and walks for 16m. Now, what is the shortest distance between Anil's final point from his starting point?

- a. 12m
- b. 13m
- c. 10m
- d. 15m

Direction Sense and distance:

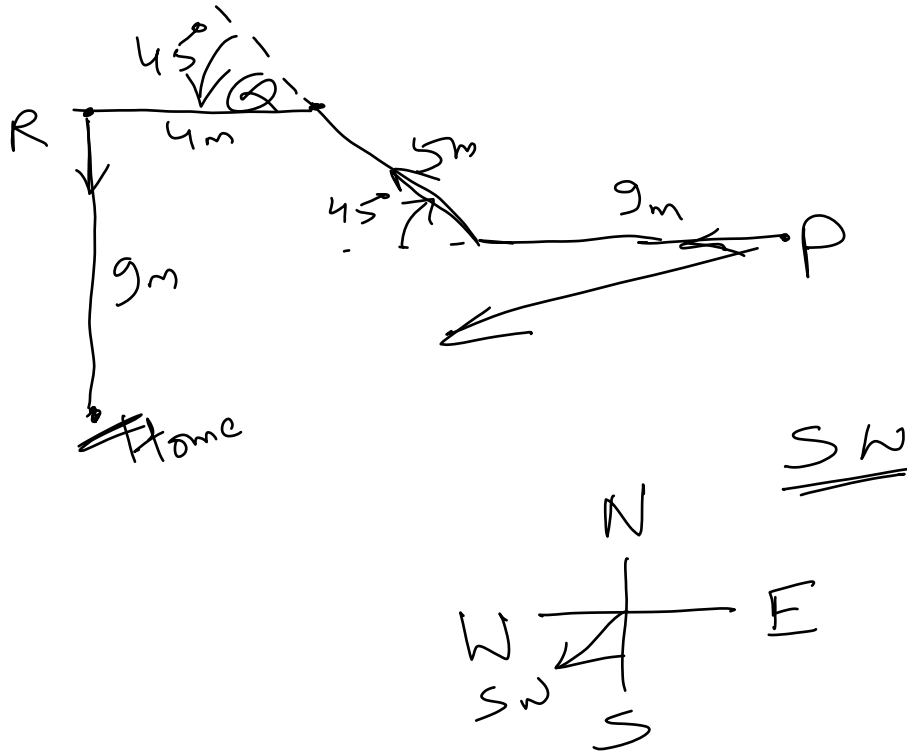

Question No 8

Suraj starts walking in west direction from point P. After covering 9m, he turns 45° clockwise direction and covers 5m to reach point Q. At point Q, he turns 45° anti-clockwise direction and covers 4m to reach point R. At point R, he turns towards his left and covers another 9m to reach his home. What is the direction of his home from point P?

a. South east

b. South west

c. West

d. North east

Direction Sense and distance:

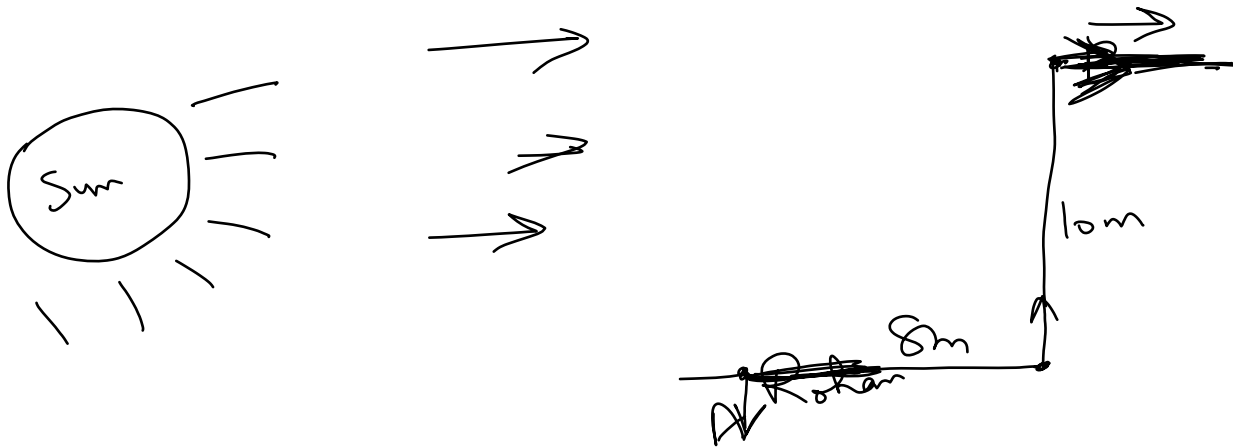

Question No 9

On a sunny day at 4:30pm, Rohan is standing at point A facing south. He turns left and walks for 8m. He turns left and covers 10m to reach point B. At point B, he turns towards right. Now, Rohan can see his shadow

- _____ .
- a. Towards his right
 - b. In front
 - c. Towards his left
 - d. At his back

Direction Sense and distance:

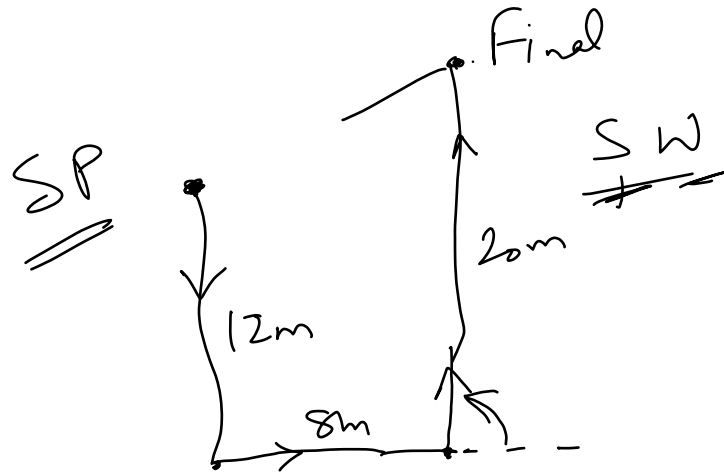

Question No 10

Amit walks for 12m towards south direction. He takes left turn and covers another 8m. He turns 90° anti-clockwise direction. After that, he walks 20m and stops. What is the direction of Amit's starting point from his final point?

- a. East
- b. West
- c. North east

~~d. South east~~ ^{West}

Direction Sense and distance:

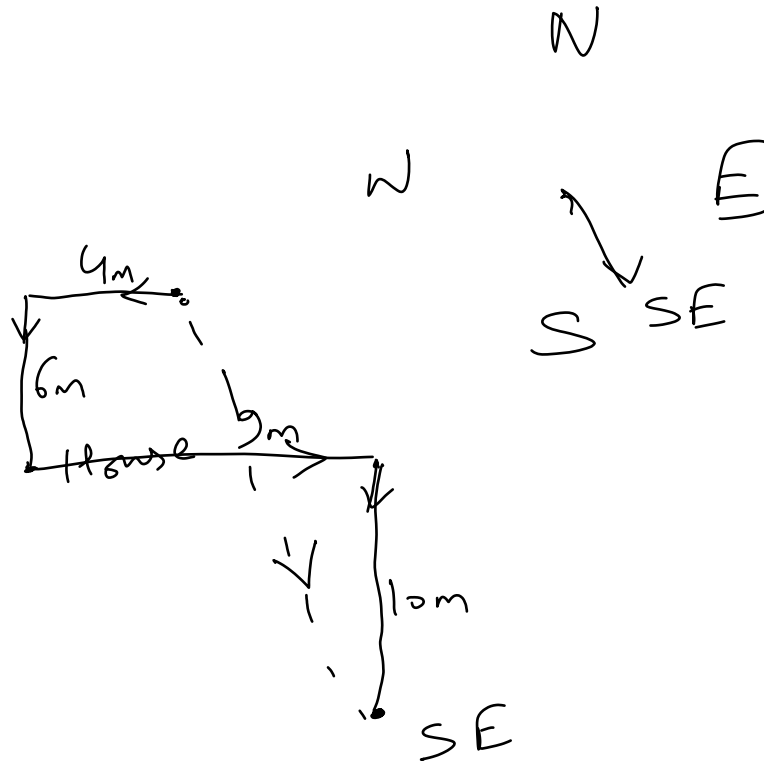

Question No 11

Rohit walks 4m towards west, then turns left and covers 6m to reach his house. From his house, he walks 9m towards east. Finally, he turns right and covers 10m. What is direction of Rohit's final point with respect to his starting Point? _____

- a. South east
- b. South west
- c. North east
- d. North west

Direction Sense and distance:

Question No 12:

B is 6m east of A. C is 4m north of B. D is 9m south of C. E is 6m east of D.
What is the shortest distance between A and E?

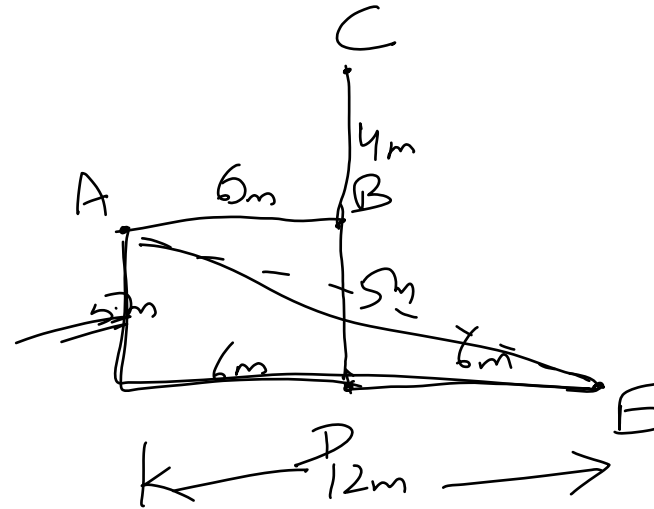

$$\begin{aligned} AE &= \sqrt{12^2 + 5^2} \\ &= \sqrt{144 + 25} \\ &= \sqrt{169} \text{ m} \\ &= \underline{\underline{13 \text{ m}}} \end{aligned}$$

- a. 12m
- b. 10m
- c. 15m
- d. 13m

Direction Sense and distance:

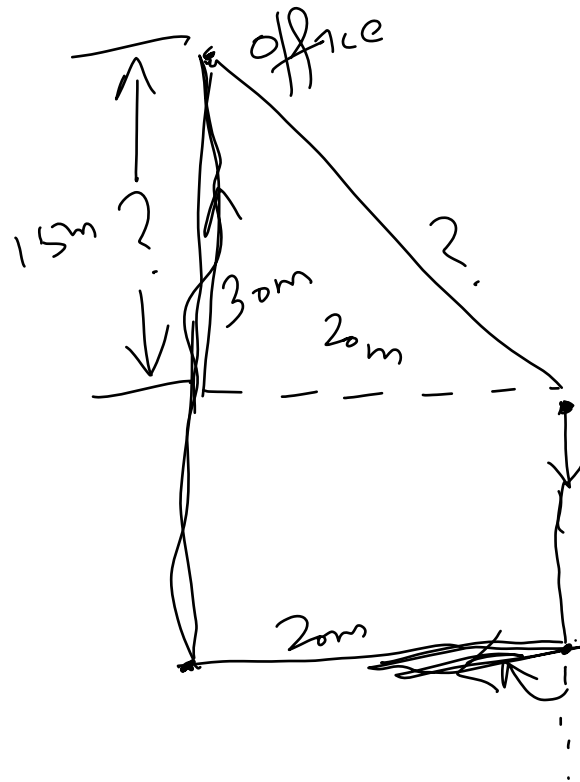

$$\begin{aligned} &= \sqrt{15^2 + 20^2} \\ &= \sqrt{(225 + 400)} \text{ m} \\ &= \sqrt{625} \text{ m} \\ &= \underline{\underline{25 \text{ m}}} \end{aligned}$$

Question No 13:

Sunil walks 15m towards south direction. Then, he turns 90° in *right* clockwise direction. He walks another 20m. He turns towards north and walks 30m to reach his office. What is the shortest distance between his starting point and office?

- a. 20m
- b. 23m
- c. 25m
- d. 30m

Direction Sense and distance:

Question No 14:

Anil walks 8m towards east. Then, he turns 270° anti-clockwise direction and walks 8m. After that, he turns right and covers another 2m. What is the shortest distance between his final point and starting point?

$$\begin{aligned} ? &= \sqrt{6^2 + 8^2} \\ &= \sqrt{(36 + 64)} \text{m} \\ &= \sqrt{100} \text{m} \\ &= \underline{\underline{10\text{m}}} \end{aligned}$$

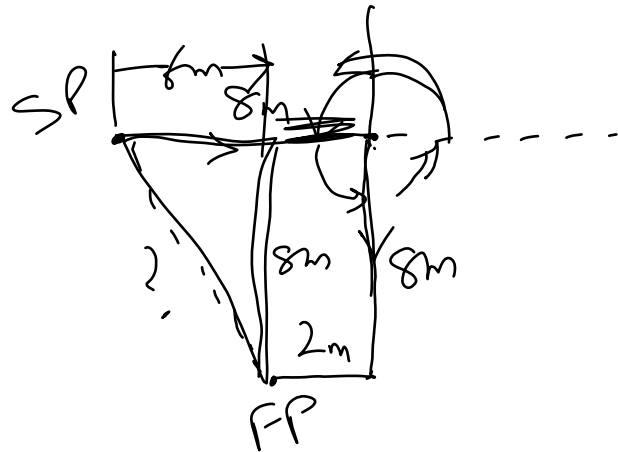

- a. 13m
- b. 10m
- c. 15m
- d. 12m